

# CAMEC MAIN DOOR CATCH-PIN AND OUTER TRIM PARTS KIT

HOOK  
CATCH x 1  
(014390)

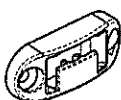

OUTER  
TRIM x 1  
(039273)

REMOTE  
CATCH-PIN  
(039316)

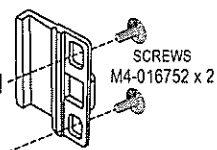

MAIN  
CATCH-PIN  
(039233)

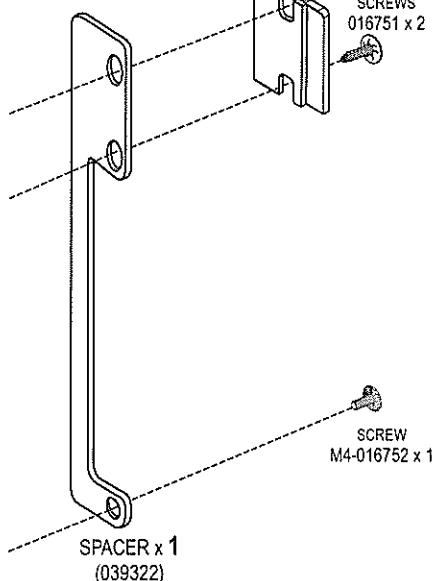
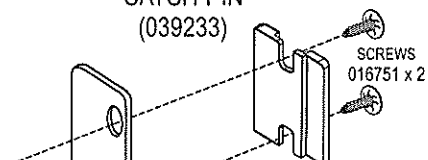

SPACER x 1  
(039322)

REMOTE  
CATCH-PIN  
(039316)

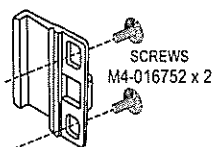

TO SUIT DOOR WITH  
NARROW FRAME (32mm)

WIDE  
CATCH-PIN  
(014389)

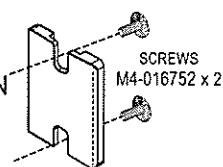

WIDE MAIN  
CATCH-PIN  
(014389)

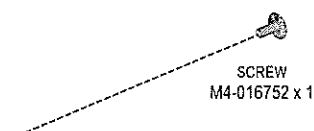
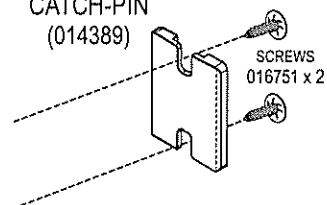

SCREW  
M4-016752 x 1

WIDE  
CATCH-PIN  
(014389)

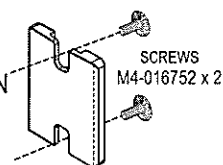

TO SUIT DOOR WITH  
WIDE FRAME (64mm)

## INSTRUCTIONS

1. Mark positions of catch-pins with pencil before removing, as they are adjustable.
2. Replace remote catch-pins - like-for-like, as there are different catch-pins depending on whether the door frame is narrow or wide.
3. Remove main catch-pin and Outer Trim. If Outer Trim has 2 mounting holes, and can't be re-used because it is damaged, an extra mounting hole needs to be drilled to suit the new Outer Trim - see *drilling instructions* on page 2.
4. Install Outer Trim and Spacer (039322). (Spacer is only used with narrow framed doors.)
5. Make sure catch-pins line up with centre of Security door latches. If not adjusted correctly, the Security Door latches will not disengage from catch-pins.