

BUSHRANGER

4x4 GEAR

X-BAR

UNIVERSAL DRIVING LIGHT BAR

NH1297 | NH1297-B

Congratulations on your purchase of the Bushranger® X-Bar. To take full advantage of this product, please read this manual carefully before using. Retain this manual for future reference for installation and warranty.

Warnings

- Before installation, please check that your vehicle's license plate mounting holes can carry the additional weight of an X-Bar and any products that you plan to mount on the X-Bar.
- Before fitting an X-Bar to your vehicle, we recommend checking with your local Roads and Traffic Authority for suitability of this product and any components to be mounted on the X-Bar (such as lights and aerials) for use on the local roads.
- Regularly inspect the X-Bar, mounting locations and attached components to ensure it is safely secured to the vehicle.
- Never use the X-Bar as a step, serious injury may result if misused.

Care & Maintenance

Prior to using your X-bar, inspect for damage. If the X-Bar or any fittings are loose, repair or remove the X-Bar prior to driving. Clean the X-Bar if necessary using PH-Neutral soapy water only.

Component List

1. X-Bar
2. Light Spacers
3. M6 x 16 Button HD Cap Screws
4. M6 x 20 Button HD Cap screws
5. M6 x 20 OD Flat Washer
6. M6 Nyloc Nut
7. Allen Key for M6 Cap Screws

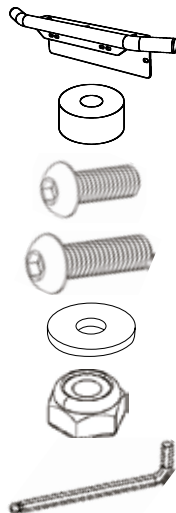

Qty

Specifications

- Part No: NH1297 (Chrome) | NH1297-B (Black)
Weight: 1340g
Dimensions: 585mm x 111mm x 88mm
Materials: Aluminium Alloy 6063-T4
(Chrome / Black Powder coat)

Installation

Note: When mounting accessories onto the X-Bar, please ensure you follow the manufacturers installation instruction supplied with the product, including torque specifications.

Step 1.

- Remove the number plate from the vehicle.
- Retain all screws.

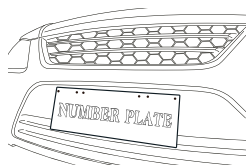

Step 2.

- Attach the X-Bar to the vehicle using 2 x M6 x 16 Button HD cap Screws, assemble with 2 x M6 x 20 OD Flat Washers.

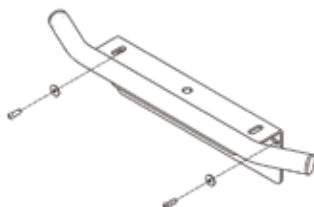

Step 3.

- Attach the number plate to the X-Bar using 2 x M6 x 16 Button HD Cap Screws and secure it using 2 x M6 x 20 OD Flat Washers and 2 x M6 Nyloc Nuts.

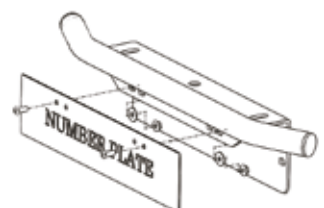

Step 4.

- Fitment is now complete.
- Your X-Bar is now ready for use.

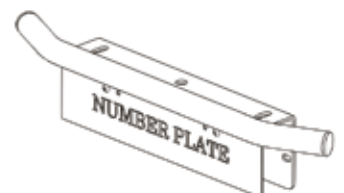

Kingsley Products - Warranty Policy

1. Our Warranty

We warrant to you that the Kingsley product is free from defects in workmanship and materials for the warranty period.

2. Fitting and use

- a. fit the Kingsley product in accordance with the product information and all relevant vehicle safety and compliance laws
- b. use the Kingsley product for the purpose for which it was originally designed and in accordance with the product information and all relevant vehicle safety and compliance laws

3. Exclusions

Our warranty doesn't cover:

- a. normal wear and tear
fitting the Kingsley product other than in accordance with the product information and any relevant
- b. vehicle safety and compliance laws, including incorrect fitting
using the Kingsley product other than for the purpose for which it was originally designed or other than in accordance with the product information and any relevant vehicle safety and compliance laws, including unusual, improper or negligent use or misuse or overloading
misuse or neglect of the Kingsley product, including improper repair or maintenance or failing to repair or maintain
alteration, abuse, acts of nature, terrorism, vandalism, collision, road hazards or adverse conditions

4. Making a claim

Please immediately contact us as soon as you become aware of a possible defect in the Kingsley product. We'll arrange for you to either attend a Kingsley outlet (at your cost) for a Kingsley representative to inspect the Kingsley product (as fitted to your vehicle) or for you to return the Kingsley product to us. We'll also request you to provide the purchase receipt and complete a warranty claim form. In order to ensure our warranty is not voided, please keep the purchase receipt as proof of purchase and don't remove the fitted Kingsley product from your vehicle before contacting us. If your claim's in order, we'll notify you and (at our sole discretion) either repair or replace the defective workmanship or materials (at our cost) or refund to you the purchase price you paid for the defective Kingsley product. If further information or investigation is required or if the claim does not meet the requirements under our warranty, we'll let you know.

5. Australian Consumer Law

The Kingsley product comes with guarantees that can't be excluded under the Australian Customer Law. You're entitled to a replacement or refund if there's a major failure and compensation for any other reasonably foreseeable loss or damage. You're also entitled to have the Kingsley product repaired or replaced if it fails to be of acceptable quality and the failure doesn't amount to a major failure.

6. Other consumer rights

The benefits to you under our warranty are in addition to any other rights and remedies you are entitled to under relevant consumer laws. Our warranty replaces any other warranty given by Kingsley or it's supplier in respect of the Kingsley product.

7. Terms

The following terms have the following meanings:

Term	Meaning
Product information	information about the Kingsley product which may be contained in any of the documentation provided with the Kingsley product, including safety instructions, installation instructions, operating instructions, owner's manual, service manual, labels and packaging
Purchase date	the date you purchased the Kingsley product from a Kingsley outlet, as specified in the purchase receipt
Kingsley outlet	an outlet authorised by Kingsley to sell Kingsley products
Kingsley products	products or components which Kingsley manufacturers or sells through Kingsley outlets
Warranty period	commences on and from the purchase date and ends as follows: X-Bar - 5 years
We/Us	Kingsley Enterprises Pty Ltd (ABN 23 001 592 749) E: sales@kingsleyenterprises.com.au A: 6A Brooks Road, Ingleburn NSW 2565 P: 1800 654 767 W: www.kingsleyenterprises.com.au
You	the purchaser of the Kingsley product from a Kingsley outlet