

THUNDER

THANK YOU FOR CHOOSING THE THUNDER 12V 800 PEAK AMP JUMP STARTER & POWER BANK

Always follow basic safety precautions when using electrical appliances. Read all instructions carefully and please keep this instruction manual for reference.



Connection to your Weekend Escape

IMPORTANT SAFETY WARNINGS

1. Read the instruction manual carefully before using this unit.
2. Jump start for 12V vehicles only. Do not use on other sized vehicles.
3. Exercise caution while using this unit.
4. Only use the jumper cable provided with this unit.
5. Make sure the blue plug of the jumper cable is plugged fully into jumping socket, otherwise, the blue plug will melt.
6. Make sure to check all the battery connections are clean before jump starting. Make sure the battery clamps are well connected. If the battery terminals on the vehicle are dirty or corroded, the unit will not work at the intended power.
7. Remove the product from the vehicle battery within 30 seconds of jump starting. If not, it could lead to damage to your car.
8. Only jump start when 3 to 4 battery indicator lights are illuminated.
9. When working with batteries make sure someone is within range of your voice to come to your aid.
10. Remove personal metal items such as rings, bracelets, necklaces when using a jump starter.
11. Charge only at ambient temperature between 0°C and 60°C.
12. Charge only using the charger provided with this unit.
13. If this unit is leaking liquid dispose of at proper recycle facility immediately.
14. Under extreme conditions, battery leakage can occur. If a liquid is noticed coming from the unit do not handle with bare hands. In case of skin contact wash with soap and water immediately. If liquid comes in contact with eyes, rinse eyes with cold running water for at least 10 minutes and get medical attention immediately.
15. Product contains lithium based battery. At the end of product life dispose of it according to local regulation.
16. Do NOT use this unit if any cable clamp or cord is damaged.
17. Do NOT use in place of a vehicle battery.
18. Do NOT use as a battery charger.
19. Do NOT leave the unit on car battery after starting the car successfully.
20. Do NOT jump start more than 3 times in a row. It could damage the unit by overheating. Give two minutes between attempts. The jumping cable can become overheated and detach as a safety measure.
21. Do NOT connect the two clamps together.

IMPORTANT SAFETY WARNINGS (CONTINUED)

22. Do NOT allow use by young or infirm persons without supervision.
23. Do NOT use as a toy.
24. Do NOT allow the product to become wet.
25. Do NOT immerse the product in water.
26. Do NOT operate the product in explosive atmospheres, such as in the presence of flammable liquids, gases or dust.
27. Do NOT modify or disassemble the unit. Only a qualified repair technician may repair this unit.
28. Do NOT expose product to extreme heat or fire.
29. Do NOT drop unit. If unit receives a sharp blow or is otherwise damaged in any way, have it checked by a qualified battery technician.
30. Do NOT store in locations where the temperature may exceed 70°C
31. Do NOT use the unit to jump start a vehicle while charging the internal battery.

PRODUCT FEATURES

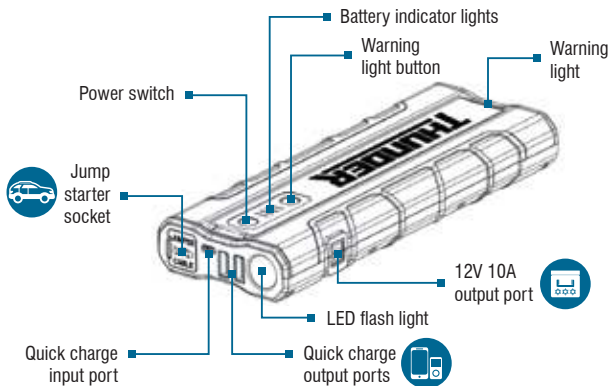

INCLUDED IN THE BOX

1 Thunder 12V 800 Peak Amp Jump Starter & Power Bank



2 Intelligent jumper cable



3 Multi USB connector



4 240V plug



5 Micro USB connector



6 12V 10A cigarette socket cable



7 User manual x 1



CHARGING INSTRUCTIONS

Charging the Jump Starter

1. Plug the home adaptor into the power socket.
2. Connect the micro connector to the quick charge input port of the Thunder 12V 800 Peak Amp Jump Starter & Power Bank.



Power Indicator

Press the on/off switch to check the storage level of the Thunder 12V 800 Peak Amp Jump Starter & Power Bank.

	OPERATION				
Indicator	Unlit	1 solid	2 solid	3 solid	4 solid
Storage Level	0%	25%	50%	75%	100%

The indicators will flash one by one during the period of charging. The different number of solid indicators show different storage levels of the Thunder 12V 800 Peak Amp Jump Starter & Power Bank. All indicator lights will turn off when the charging process has been paused or completed.

JUMP STARTING INSTRUCTIONS

Jump Starting 12V Vehicles

1. Connect the blue plug to the unit and make sure the cable indicator is off. The plug must be fully seated into the host.
2. Connect the red clamp to the positive (+) battery terminal, and the black clamp to the negative (-) battery terminal.
3. Start the vehicle.
4. When the vehicle has been jump started, remove the jumper cable from the vehicle and leave the engine running.

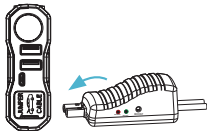

CABLE INDICATOR INSTRUCTIONS

Green light on

Telling the connection is correct and the circuit is working, you can turn on the engine to jump-start directly.

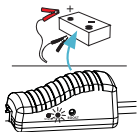

Red light on with buzzing noise

The connection is incorrect. Check you've attached the clamps to the correct terminals. Wait until the green light is on to turn on the engine.

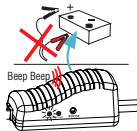

Green light blinking with buzzing noise

The vehicle battery is low. Press the BOOST button, wait until the green light becomes solid, then turn on the engine within 30 seconds.

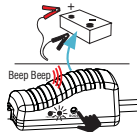

No lights on and no buzzing noise

The vehicle's battery maybe damaged. Confirm the clamp connection is correct. If so, press the BOOST button, wait until the green light is on, and then turn on the engine within 30 seconds.

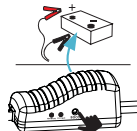

POWERING DEVICES

Charging a Mobile Phone or Tablet

1. Plug the device cable to the quick charge USB output port.
2. Select the appropriate connector and connect it to your mobile phone or tablet.
3. Press the Power switch button; it will automatically adjust output to provide the optimum charge for mobile devices.

Power Supply to 12V Vehicle Products or 12V Electronics

1. Plug the cigarette lighter plug into the 12V 10A output port.
2. Connect the device cable and 12V vehicle product or 12V electronics.
3. Press the switch button to supply power.

LED FLASHLIGHT INSTRUCTIONS

LED Flashlight: Press the switch for 3 seconds to start the LED flash light. Press the button to cycle through each of the three modes of LED light - normal, strobe, SOS, off.

Warning Light/White LED light: The red warning light can be used to alert other drivers of your vehicle or signal for help. The white LED light is a flood light to illuminate larger areas. Touch the button to start warning light function, and click button to change to white LED light mode, then push button again to turn off.

PRODUCT SPECIFICATIONS

Size:	225mm (L) x 89mm (W) x 30mm (D)
Weight:	630g
Battery Capacity:	18000mAh (66.6Wh)
Output:	Dual Quick Charge 5V 2.4A; 9V 2A; 12V 10A; 12V jump start
Input:	Quick Charge 5V 2A; 9V 2A
Charging Time:	Approximately 4-5 hours
Start Current:	400A
Peak Current:	800A
Operating Temperature:	-20°C to + 60°C

TROUBLESHOOTING

Problem

There is no response when pressing the power button.

Reason

This means there is a low voltage protection on the Thunder 800 CCA Jump Starter.

Solution

Recharge the unit. Plug the adaptor into the quick charge input port.

FAQs

Q: How do I turn off my Thunder 12V 800 Peak Amp Jump Starter & Power Bank?

A: It will automatically turn off when it has finished loading or when charging is complete.

Q: How long does it take to fully charge the Thunder 12V 800 Peak Amp Jump Starter & Power Bank?

A: Approximately 4-5 hours through the quick charge input.

Q: How many times can the Thunder 12V 800 Peak Amp Jump Starter & Power Bank charge my mobile phone?

A: This depends on the battery capacity of your mobile phone.

Q: How many times can this fully charged unit jump start my vehicle?

A: Approximately 40 times, however it depends on the size and capacity of your vehicle.

Q: What's the estimated lifetime of the Thunder 12V 800 Peak Amp Jump Starter & Power Bank?

A: Approximately 3-5 years in normal conditions.

Q: How long can the Thunder 12V 800 Peak Amp Jump Starter & Power Bank be left unused and still jump start a car after charging?

A: It is advised to recharge the jump starter every three months however it is expected to hold charge for 6-12 months.

Applied Standard:
GB/T 18287-2000



WARRANTY

When you acquire or fit a Thunder product you have the peace of mind in knowing that it is backed by a comprehensive 12 month warranty against defects in materials and workmanship. The Thunder warranty is provided in addition to any rights you may have under the Australian Consumer Law.

All claims under this warranty should be made by returning the product to the place of purchase at your expense, with the detail of the fault, proof of purchase and fitment details. If we determine that a Thunder product is defective in materials or workmanship during the warranty period, we will either repair or replace the unit.

This warranty does not apply to failure or damage to a Thunder product caused by incorrect or faulty fitment, accidental or intentional damage, failure of other products, incorrect application, incorrect voltage, environmental damage, operation of the product outside of its environmental and technical specifications, or repair or modification carried out by anyone other than an authorised repairer.

Our goods come with guarantees that cannot be excluded under the Australian Consumer Law. You are entitled to a replacement or refund for a major failure and compensation for any other reasonably foreseeable loss or damage. You are also entitled to have the goods repaired or replaced if the goods fail to be of acceptable quality and the failure does not amount to a major failure.

ADDITIONAL THUNDER PRODUCTS

60L FRIDGE/FREEZER
Part No. TDR02101



240 WATT FOLDING SOLAR PANEL
Part No. TDR15007



23L FRIDGE DRAWER
Part No. TDR02100



RECOVERY KIT
Part No. TDR04010



BATTERY BOX
Part No. TDR02007



THUNDER CAM
Part No. TDR17011



20 AMP DC-DC CHARGER WITH MPPT SOLAR REGULATOR
Part No. TDR02020



LOW PROFILE LED WORK LIGHT
Part No. TDR08109

