

MYCOOLMAN

CCP Fridge-Freezer

Operation Manual for AC/DC Fridge-Freezer

Single Zone Models **CCP 36 / 44 / 60 / 73 / 105**

Dual Zone Models **CCP 69 / 96**



Contents

Important Safety Warnings	page 2
Important Product Information	page 3
Product Features	page 3
LED Control Panel	page 4
Multi Voltage System / Emergency Override	page 5
Two way opening and removable lid	page 5
Smart Phone App Instructions	page 6
Cleaning & Maintenance	page 6
Troubleshooting / Fault Indicator	page 7
Product Specifications / Technical Data	page 8
Warranty Terms & Conditions	page 8

Important Safety Warnings

- Do not use if any of the electrical cables, flexes and plugs are worn or frayed. Replace with original manufacturers parts.
- Always check cables for mechanical damage, cuts in the insulation, heat / moisture damage before use. If in any doubt REPLACE.
- Do not handle electrical flexes with wet hands.
- Do not place electrical items in refrigerator.
- Best performance is achieved under ambient temperatures between +10 °C and + 32 °C, beyond 32 °C the performance will drop and power consumption increase.
- If your fridge/freezer has been off with food stored, do not consume if in any doubt!
- Repairs should only be carried out by a suitably qualified and authorized person. Poor repair could be dangerous.
- Do not store dangerous items in the appliance, such as spray cans, explosives, and flammable liquids / propellants.
- Do not operate this appliance in the rain.
- Do not allow children to play with the appliance.
- Small children must be supervised when around all electrical appliances.
- Do not allow children or pets to climb inside appliance.
- Always disconnect before cleaning.
- Food must be stored in suitable and appropriate containers.
- If your appliance is plugged in to a DC vehicle socket – ensure that you disconnect from power when you stop. Or use the battery protection (page 4) Don't come back to a flat battery!
- Do not fill appliance with ICE, WATER or other liquid.
- Do not attempt to remove frost with scraper or knife. Serious damage to cooling system could occur.
- Buildup of heat in a vehicle can be extreme, "shutdown" will occur if cooling is not possible.

myCOOLMAN CCP Fridge-Freezer

Important Product Information

- When using the unit ensure the circuit being used has a fuse or circuit breaker, recommended size for DC 12 Volt is 10 Amp, DC 24 Volt is 5 Amp.
- Make sure the voltage is within the correct range for socket and cable being used.
- Do not place any electrical devices inside the refrigerator as they may be damaged.

Damage may occur if the DC cable supply is undersized. This will cause low voltage. As a guide, from the battery to the appliance follow this guide.

Cable cross section	12V maximum cable length	24V maximum cable length
mm ²	Metre	Metre
2,5	2,5	5
4	4	8
6	6	12
10	10	20

1. Your unit requires good ventilation, especially around the vents of the refrigerator; allow a gap of at least 100 mm around all vents.
2. The lower the ambient temperature, the lower the power usage. In order to maximise efficiency keep the unit in a cool location out of direct sunlight.
3. Do not allow a large amount of frost to build up on the inside walls as this may impair cooling.
Defrost by turning the unit off, allowing the frost to melt and wipe out the water.
4. It is recommended to operate the unit on a flat surface, but it will operate at angles up to 30 °.

At inclinations of more than 15 ° the compressor noise level may increase (without any effect on the cooling performance)

Product Features



- 1 Powered by 12/24 Volt DC compressor
- 2 Two way opening lid (not CCP 36/44)
- 3 Bottle openers on both sides
- 4 Flat carry and tie down handles
- 5 Digital display for each compartment (only Dual Zone models)
- 6 Multi-voltage system AC (240V) and DC (12/24V) with battery protection DC inlet on two ends
- 7 USB port and charger with 3000 mA
- 8 Stylish robust corners for protection
- 9 LED interior light
- 10 Divided compartment storage
- 11 Fully refrigerated stepped compartment
- 12 Headroom for upright standing bottles
- 13 Bluetooth App for mobile use

LED Control Panels / Bluetooth Mode

Control Panel Single Zone (CCP 36 / 44 / 60 / 73 / 105)

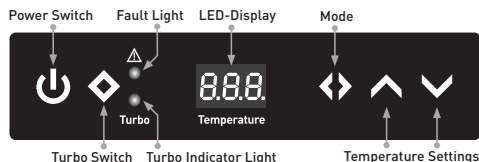

Control Panel Dual Zone (CCP 69 / 96)

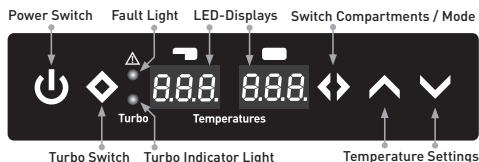

Temperature setting range –18 °C to +10 °C in each compartment

- Plug in the AC or the DC power cable.
- Press button to turn on unit. The LED display on the control panel will turn on and the interior temperature is displayed. Press the button for **3 seconds** to switch off the unit. The system has a memory which records your last setting before shut down. If the power supply is cut off or disconnected, the unit will switch off automatically and once the power supply is restored it will automatically switch back on.
- Use the button to increase or the button to decrease the temperature.
- Press the button for **Turbo mode** to increase the speed of the compressor. This setting can be used when you need to cool products faster.
- Press the button **1 time** to change the temperature setting between the two compartments (only Dual Zone units)
- Press the button **2 times** to switch between °F or °C for Single Zone models and **3 times** for Dual Zone models. °F or °C will be shown at the display. Then press the or button to change.
- Press the button **1 more time** (after change °F or °C), to enter **battery protect voltage** setting. Then press the or button to choose HI, MED or LO of protect level.

Battery protect level:	On (12 V)	Off (12 V)	On (24 V)	Off (24 V)
LO:	11.1 ± 0.3	10.1 ± 0.3	23.3 ± 0.3	21.5 ± 0.3
MED:	12.2 ± 0.3	11.4 ± 0.3	25.3 ± 0.3	24.1 ± 0.3
HI:	12.6 ± 0.3	11.8 ± 0.3	26.2 ± 0.3	24.6 ± 0.3

- Press the button **1 more time** (after battery protect voltage setting), to enter **Bluetooth activation mode**. Then press the or button to choose ON or OFF. (See more on page 6)
- Press the and button for **3 seconds**, at the same time to enter the **Bluetooth mode**.
CLO: Connect to the refrigerator by scan the QR code only.
OPE: Scan and find your refrigerator by mobile Bluetooth, and then connect.
- For the Dual Zone models, press the button for **3 seconds**, and you can switch off the cooling function of the compartment on the left. Also press the button for **3 seconds**, you can switch off the cooling function of the compartment on the right. Press again for **3 seconds** to re-start refrigeration in compartment.

myCOOLMAN CCP Fridge-Freezer

Multi Voltage System / Emergency Override

**AC/DC, USB connection and
Emergency Override in front ...**

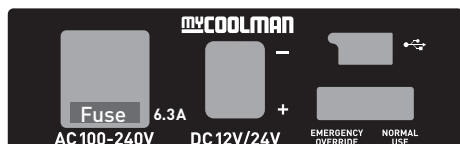

Emergency Override Switch

For normal operation the switch is in the "NORMAL USE" position. If an electronic control or display board failure occurs, slide the switch to "EMERGENCY OVERRIDE" position. In this case, the cooler runs with full cooling capacity and may freeze.

**... and also DC connection
on the back side**



The second DC socket

allows the optimal use in every position. Here you also find the serial number of your device.

Two way opening and removable lid

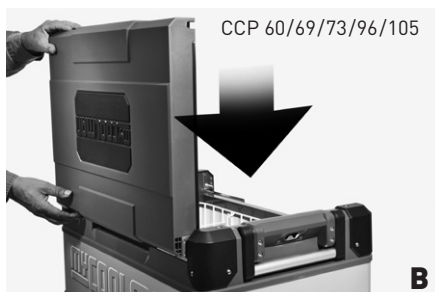
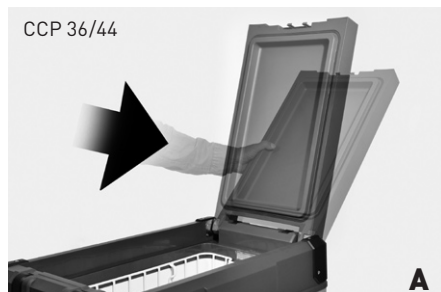

A. Open the lid fully, then over extend, pushing lid past this point to remove. [all models]

B. Turn the lid and put it vertically on the opposite side of the box and press it down firmly. [CCP 60/69/73/96/105]

Smart Phone App Instructions



To control your Fridge·Freezer with your smartphone you can use the MyCOOLMAN smartphone app.

Activate the Bluetooth function of your phone. Then search for the MyCOOLMAN Fridge Application in the Google Play or Apple App Store to download from there for free.

When you open the app you will see picture **A**. Then click **Add device** to search for the fridge and you will see the available equipment, as shown in **B**.

Click your CCP model to connect the fridge, finally you will see picture **C** which shows connection successful.

Or as an alternative, scan the individual **QR code** which is delivered with the fridge for connecting fridge/freezer and app, then will directly enter to picture **C**.

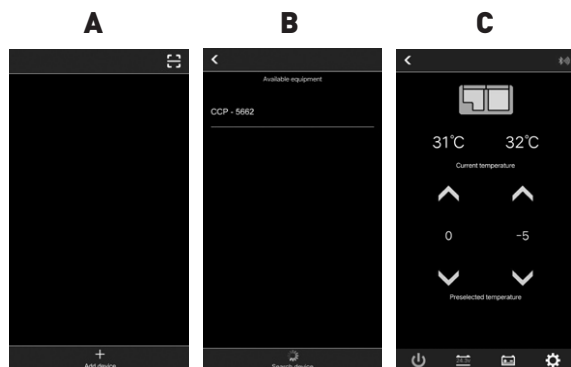

Now linked to your CCP, you may

- turn your fridge on and off,
- choose between Celsius and Fahrenheit temperature scales,
- adjust the fridge temperature between +10 °C and -18 °C,
- switch between several fridges,
- turn the turbo mode on and off.
- choose the battery protection level (see chart page 4),
- check the current temperature,
- monitor the current battery voltage,
- recognize any default immediately,
- personalize your refrigerator name.

Cleaning & Maintenance

- Clean the appliance inside and outside with a clean damp cloth every week.
If it is dirty, use sodium bicarbonate dissolved in lukewarm water to clean the unit.
- Please don't use abrasive products, detergents, soap or hard objects to clean as these can damage your refrigerator.
- After cleaning, wipe out with a clean damp cloth and dry carefully.
- Never clean the unit under running water or in dish water.
- Do not store products inside unit if the unit is off.
- Do not store the unit if it is wet inside or without leaving the lid open.

Troubleshooting

The unit is not turning on

- Check whether the unit has been turned on.
- Check the power supply (try a different power source/vehicle/socket).
- Check whether the plug and the socket have a good connection.
- Check whether the fuse has been burned out or blown.

Low refrigeration performance

- Too much product has been placed inside the unit.
- There is too much warm product inside the unit.
- The lid is unlatched or open.
- The lid seal is broken.
- Poor ventilation (allow 100 mm of space around all vents).
- The ambient temperature is too high.
- The temperature setting is too high.

Can hear the sound of liquid flowing or gurgling from inside the unit

- This is normal, due to the flow of refrigerant in the unit.

Unusual noise when refrigerator is working

- The refrigerator is not placed on a level surface. If none of the above solves your issue see page 3 or contact MyCOOLMAN

When the LED display will show E0, means NTC (the temperature sensor) broken circuit or short circuit.

Please noted that the fault indicator will always be green if normal. When flashing, it will change to orange color.

Fault Indicator

Orange fault light flashing!

ER 1 flash every 4 seconds - low voltage:

- Try on different power source (vehicle or 240V AC power). If changing power source fixed issue, then possible issue with original power source.
- Ensure cabling between fridge and battery is at least 1.5 mm², if the distance is more than 2 metres use at least 2.5 mm² cable.

ER 2 flashes every 4 seconds - fan issue:

- Fan is drawing too many amps (over 0.6 amps), replace fan.

ER 3 flashes every 4 seconds - compressor start issue:

- Unplug cable and allow unit to rest for 10 minutes.
- Try on different power source (vehicle or 240 V AC power).
- Electronic box fault.
- Compressor fault.

ER 4 flashes every 4 seconds - low motor speed:

- Reduce products/items inside unit.
- Move so unit is in a lower ambient temperature, clean vents/ensure clear air flow over compressor.
- Fan fault.

ER 5 flashes every 4 seconds - over temperature:

- Ambient temperature too high.
- Clean vents/ensure clear air flow over compressor.
- Fan fault.

Product Specifications / Technical Data

Model	CCP 36 Single Zone	CCP 44 Single Zone	CCP 60 Single Zone	CCP 73 Single Zone	CCP 105 Single Zone	CCP 69 Dual Zone	CCP 96 Dual Zone
Dimensions mm	Length 652 Width 412 Height 428	Length 652 Width 412 Height 488	Length 732 Width 456 Height 488	Length 732 Width 456 Height 555	Length 912 Width 536 Height 500	Length 732 Width 456 Height 555	Length 912 Width 536 Height 500
Weight / kg	18	20,5	23,5	25	28,6	27,2	31,8
Connection Voltage	DC 12/24V --- / AC 100-240V~ 50-60Hz						
Rated current	12V --- 3.40 A 24V --- 1.70 A 240V ~ 0.44 A	12V --- 3.80 A 24V --- 1.90 A 240V ~ 0.30 A	12V --- 5.60 A 24V --- 2.90 A 240V ~ 0.30 A	12V --- 5.90 A 24V --- 3.00 A 240V ~ 0.30 A	12V --- 5.50 A 24V --- 2.80 A 240V ~ 0.32 A	12V --- 5.30 A 24V --- 2.80 A 240V ~ 0.31 A	12V --- 5.80 A 24V --- 2.90 A 240V ~ 0.34 A
USB	5V / 3000 mA						
Climate class	N, T						
Refrigerant/ Quantity	R134a / 43g	R134a / 45g	R134a / 65g	R134a / 70g	R134a / 100g	R134a / 75g	R134a / 96g
Cooling capacity	- 18 °C to +10 °C [0 °F to +50 °F]						
Volume/litres	36	44	60	73	105	69 (24/45)	96 (41/55)

Warranty Terms & Conditions

When you buy MyCOOLMAN Fridge-Freezer you have peace of mind knowing that it is backed by a comprehensive 3 year warranty against defects in materials and workmanship plus 2 years (parts only) on the compressor. The MyCOOLMAN warranty is provided in addition to any rights provided under Australian Consumer Law. All claims under this warranty should be made by returning the product to the place of purchase at your expense, with the detail of the fault, proof of purchase and fitment details. If we determine that a MyCOOLMAN product is defective in materials or workmanship during the warranty period, we will either repair or replace the unit. This warranty does not apply to failure or damage to a MyCOOLMAN product caused by incorrect or faulty fitment, accidental or intentional damage, failure of other products, incorrect application, incorrect voltage, environmental damage, operation of the product outside of its environmental and technical specifications, or repair or modification carried out by anyone other than an authorised repairer.

Designed in Germany, made in China for

